

OUTLINE DIMENSIONS OF MODEL 880-150 LINED BALL CHECK VALVE

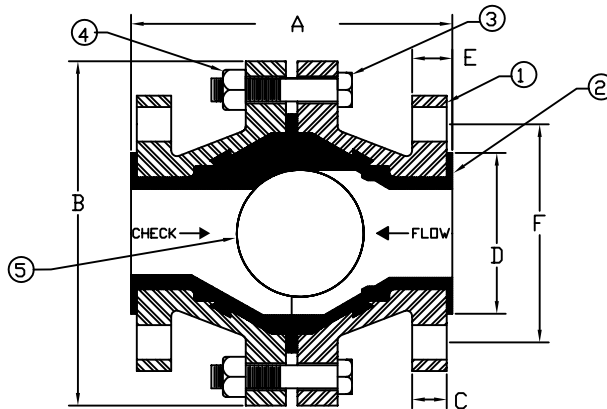

NOTE: THIS DESIGN INTENDED FOR VERTICAL PIPING INSTALLATIONS - FLOW UP - CHECK DOWN

PART NUMBER	NOMINAL VALVE SIZE	A	B	C APPROX.	D	E APPROX.	F			APPROXIMATE WEIGHT - LBS.	
							NUMBER OF HOLES	BOLT HOLE DIAMETER	BOLT CIRCLE DIAMETER	VALVE	BALL
01-880-150	1"	6"	5.5"	0.56"	2"	0.69"	4	0.63"	3.13"	12	0.17
1H-880-150	1.5"	7"	6.5"	0.69"	2.88"	0.81"	4	0.63"	3.88"	22	0.44
02-880-150	2"	7"	7.5"	0.75"	3.63"	0.88"	4	0.75"	4.75"	29	0.87
03-880-150	3"	8"	9.25"	1.0"	5"	1.13"	4	0.75"	6"	50	2.44
04-880-150	4"	10.5"	11.75"	1.0"	6.19"	1.19"	8	0.75"	7.5"	86	5.84
06-880-150	6"	15.5"	17.37"	1.06"	8.5"	1.25"	8	0.88"	9.5"	196	18.9

BILL OF MATERIAL				
PART NUM.	PART NAME	QUANTITY	MATERIAL	ASTM NUMBER
1	BODY HALF	2	DUC.IR.	A395
2	LINER	2	AS SPECIFIED	N/A
3	BOLT	*	ALLOY STEEL	A449
4	NUT	*	ALLOY STEEL	A194
5	BALL	1	PTFE	N/A

* - 1" AND 1.5" SIZES = 4
2" THRU 8" SIZES = 8

NOMINAL VALVE SIZE	PRESSURE DROP LIMIT IN THE CHECK POSITION - PSI
1"	70
1.5"	65
2"	60
3"	55
4"	50
6"	40

TOLERANCES:
A AND B = + - 0.125"
ALL OTHERS = + - 0.063"

3 2 1	ADDED TITLE & PRESSURE DROP CHART	7-8-06	B.K.	This drawing shall not be reproduced, copied, published, or disposed of, directly or indirectly, nor used for any purpose other than that for which it was specifically furnished	ChemValve, Inc. Tomball, Texas			
	CHANGED PART NUMBER TO NEW SYSTEM	1-31-00	B.K.		Model Number 880 - DIMENSION DRAWING			
	CHANGED BODY HALF MAT. TO DUCTILE IRON ASTM A395	5-22-98	B.K.		Drawn: B.K.	Part Name 880		
					Checked:	Drawing Number 880DIM1		
No.	Revision Description	Date	Chk'd		Approved: B.K.	Date: 6-2-97	Rev. 3	